

# Paint & Varnish Processing

## Drop-Through Rotary Valves RV / RVR



23



### Description ▼

RV Drop-Through Rotary Valves consist of a tubular cast iron or stainless steel casing, a horizontally mounted rotor with a certain number of V-shaped cross section compartments, a drive unit and a casing cover opposite the drive end.

### Function ▼

RV Rotary Valves have been developed for maximum versatility in application. They are suitable for controlled discharging and feeding of powdery or granular materials from silos, hoppers, pneumatic conveying systems, or cyclones.



### Application ▼

RV-RVR Rotary valves are fitted at the outlet of silos, bins or hoppers for feeding the discharged material with high accuracy into the downstream process.

### Benefits ▼

- ✓ Air-purged seals;
- ✓ Square or round flanges ensure system compatibility and match with WAM® flanges;
- ✓ Cast iron or SS, nickel coating, chrome-plated casing, as well as various rotor versions available to ensure the most appropriate configuration for application requirements;
- ✓ Quick integration into the process thanks to easy handling;
- ✓ Modular design and easy maintenance thanks to few components.

# Paint & Varnish Processing

## Drop-Through Rotary Valves RV / RVR



### Technical Features / Performance ▼

- ▶ Capacity: 2.2 ~ 19.5 litres per revolution (0.08 ~ 0.7 cu ft per revolution)
- ▶ Working temperature: - 20° C ~ 150° C (- 4° F ~ 300° F)
- ▶ Maximum differential pressure: 0.3 bar (4.4 psi)
- ▶ Cast iron or SS design
- ▶ Nickel coating or chrome-plated casing for abrasive materials available
- ▶ Rotor with beveled blades or replaceable tips available
- ▶ Sturdy compact structure
- ▶ Small footprint
- ▶ Drive unit mounted directly on shaft without further bearing assembly or coupling
- ▶ Square or round flanges and inlet spouts
- ▶ Compatibility with WAM® standard flanges on inlet and outlet

### Overall Dimensions ▼

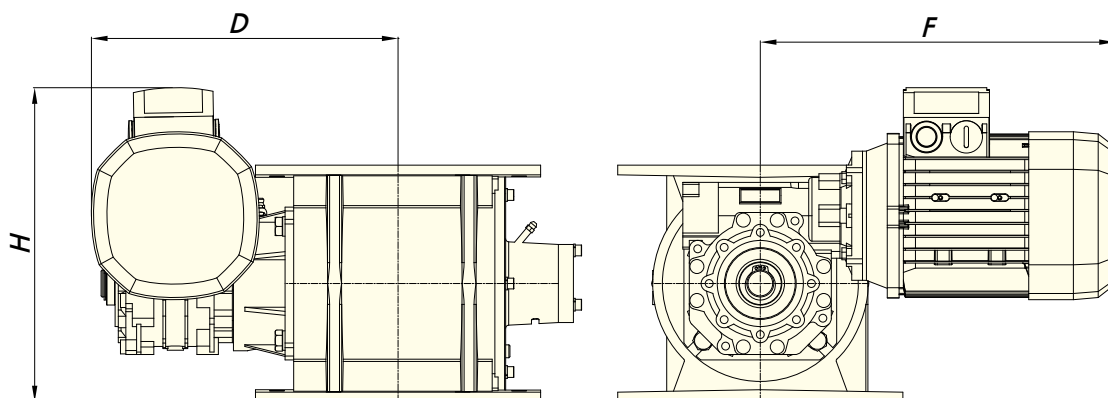

| TYPE             | D*  | F*  | H*  |     | kW   |
|------------------|-----|-----|-----|-----|------|
|                  |     |     | RV  | RVR |      |
| RV/RVR 02 30 rpm | 294 | 350 | 318 | 333 | 0.5  |
| RV/RVR 02 20 rpm |     |     |     |     | 0.75 |
| RV/RVR 05 30 rpm | 328 | 394 | 348 | 373 | 0.5  |
| RV/RVR 05 20 rpm |     |     |     |     | 1.1  |
| RV/RVR 10 30 rpm | 364 | 419 | 425 | 472 | 0.75 |
| RV/RVR 10 20 rpm |     |     |     |     | 1.5  |
| RV/RVR 20 30 rpm | 392 |     |     |     | 1.1  |
| RV/RVR 20 20 rpm |     |     |     |     |      |

DS-RV-RVR-EN-September 2015.000  
Rights reserved to modify technical specifications.